

KEY MAP PROJECT LOCATION

BARTLETT PARK BASKETBALL COURT RENOVATION INDEX OF DRAWINGS	
SHEET	SHEET TITLE
1	EXISTING BARTLETT PARK SITE LAYOUT PLAN
2	PROPOSED BARTLETT PARK SITE LAYOUT PLAN
3	PROPOSED BARTLETT PARK BASKETBALL COURT STRIPING DETAILS
4	PROPOSED BARTLETT PARK BASKETBALL COURT SIDEWALK DETAILS
5	PROPOSED BARTLETT PARK BASKETBALL COURT PATIO DETAIL

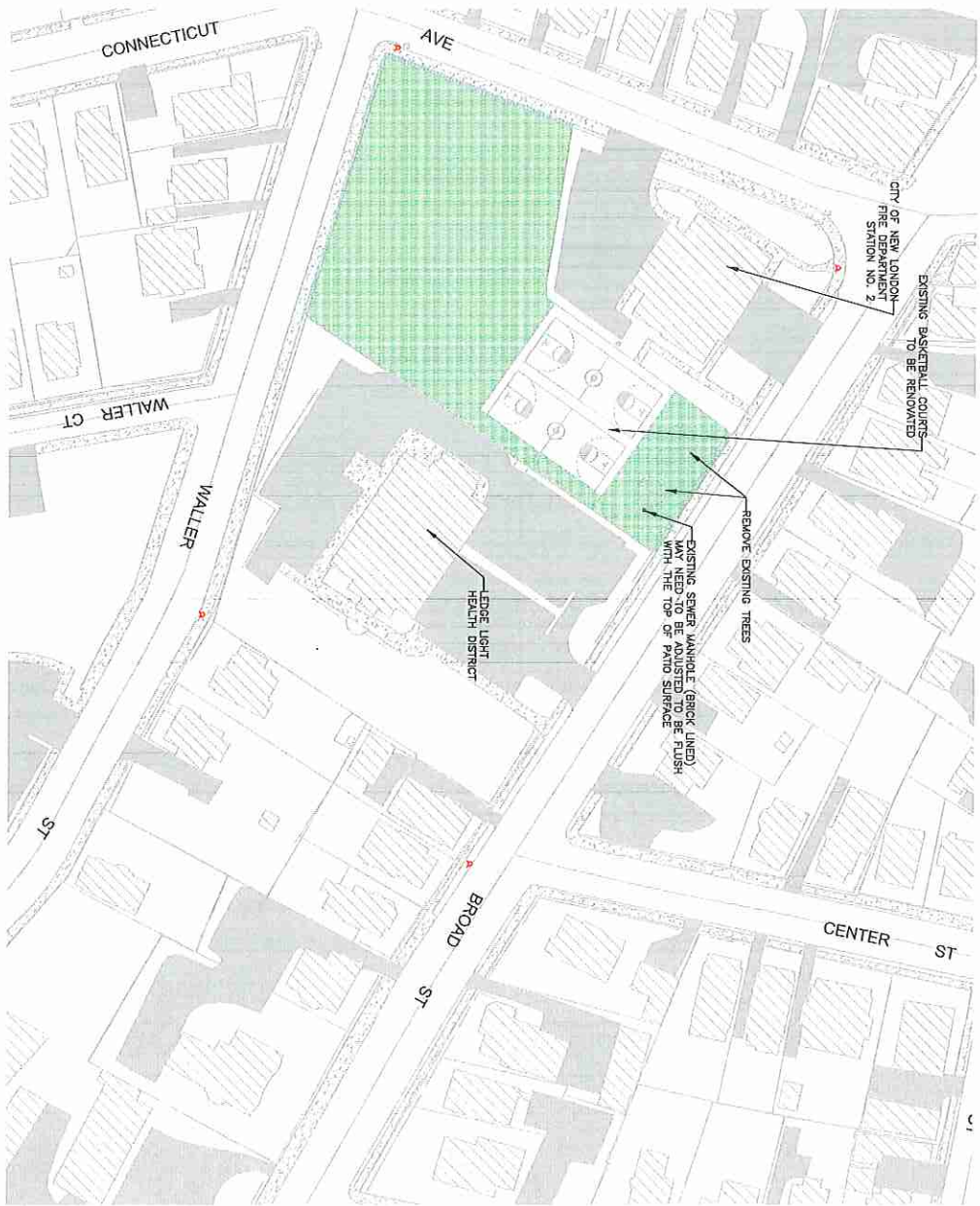

EXISTING SITE LAYOUT PLAN
FOR BARTLETT PARK
BASKETBALL COURT RENOVATION
REVISION - 1
DRAFT 1/8/18
NOT ISSUED FOR CONSTRUCTION



REVISIONS			
NO.	BY	DATE	DESCRIPTION
DRAWN BY: TQJ			APPROVED BY: XXX
			DATE: 1.8.2018

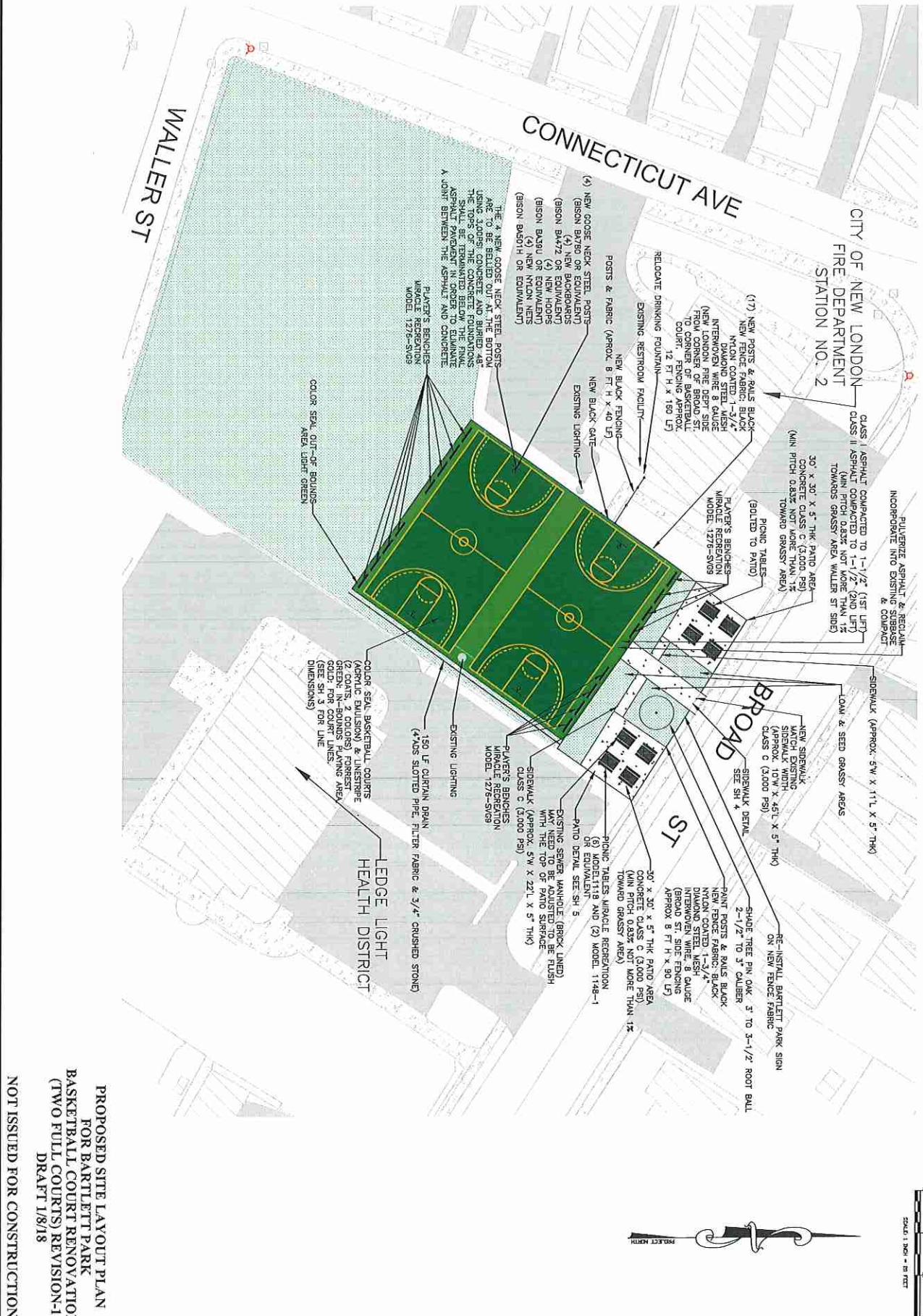

PROPOSED SITE LAYOUT PLAN
FOR BARTLETT PARK
BASKETBALL COURT RENOVATION
(TWO FULL COURTS) REVISION-1
DRAFT 1/8/18



REVISIONS			
NO.	BY	DATE	DESCRIPTION

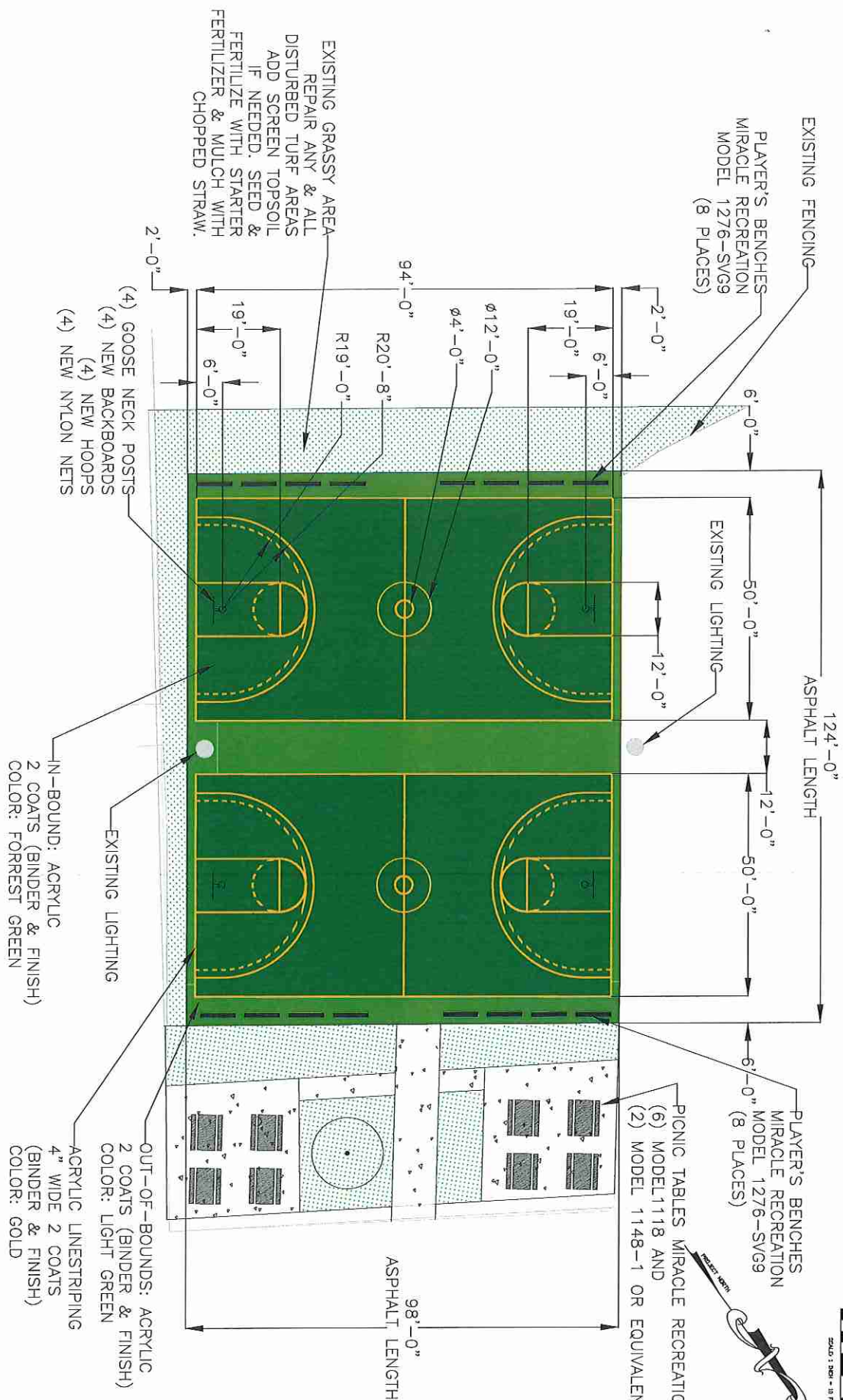

PROPOSED STRIPING DETAILS
FOR BARTLETT PARK
BASKETBALL COURT RENOVATION
(TWO FULL COURTS) REVISION-1
DRAFT 1/8/18



REVISIONS			
NO.	BY	DATE	DESCRIPTION

DRAWN BY: TQJ APPROVED BY: XXX DATE: 1.9.2018

NOTES:

1. CONSTRUCT SIDEWALK TO EXISTING SIDEWALK WIDTH. EXISTING SIDEWALK IS APPROXIMATELY 10' WIDE.
2. SIDEWALK SHALL BE CLASS "C" CONCRETE (3,000 PSI) 5" THICK.
3. METAL DOWELS ARE TO BE INSERTED EVERY 30 FEET.
4. 6" X 6" WELDED WIRE MESH REINFORCING SHALL BE INSTALLED 1-1/2" ABOVE THE 6" COMPACTED PROCESSED AGGREGATE BASE.
5. 1/2" THICK EXPANSION JOINT MATERIAL SHALL BE INSTALLED BETWEEN THE BASKETBALL COURT ASPHALT AND EXISTING SIDEWALK AND AT 15 FEET INTERVALS.
6. SIDEWALK SHALL BE FLUSH WITH EXISTING SIDEWALK EDGE AND FLUSH WITH FINISHED BASKETBALL COURT'S ASPHALT EDGE.
7. THE SURFACE AREA OF THE SIDEWALK SHALL HAVE A STIFF BROOM FINISH.
8. REPAIR ANY AND ALL DISTURBED TURF AREAS. ADD SCREENED TOPSOIL AS NEEDED. SEED AND FERTILIZE WITH STARTER FERTILIZER AND MUCH WITH CHOPPED STRAW.

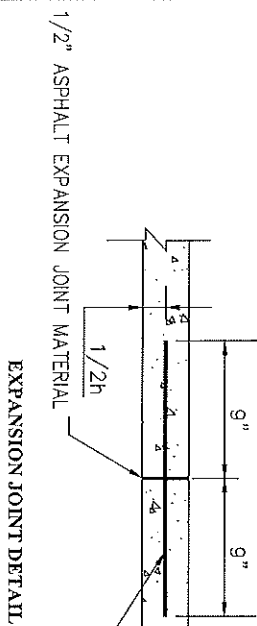
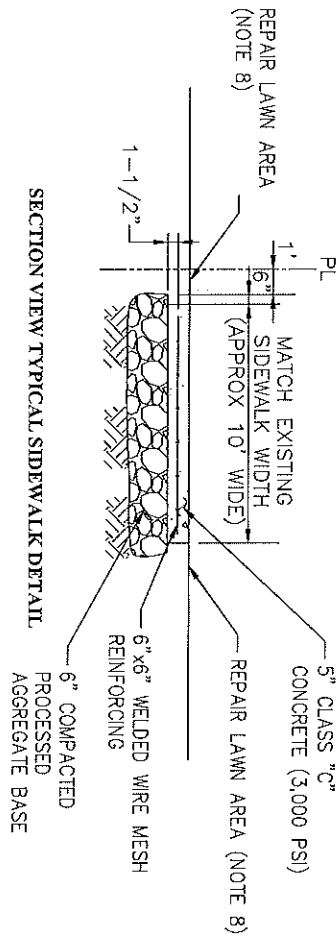
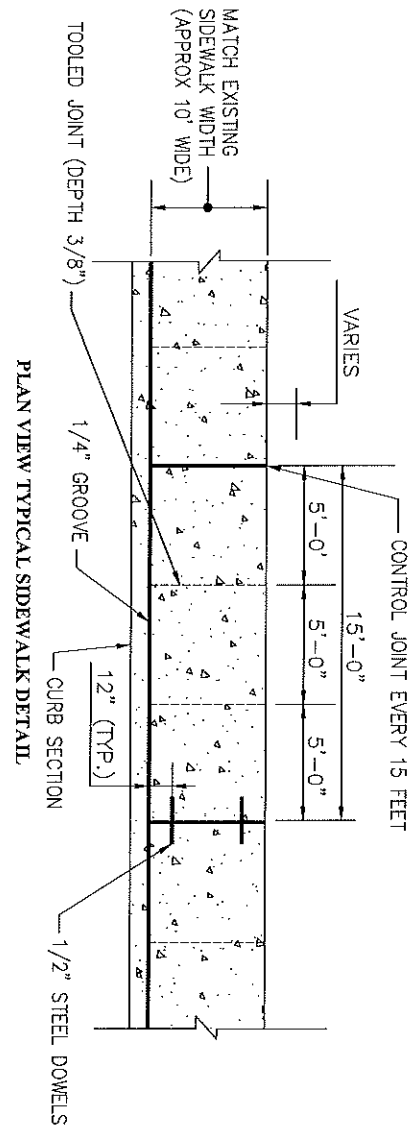

PROPOSED SIDEWALK DETAIL
BARTLETT PARK
BASKETBALL COURTS
(NOT TO SCALE)
REVISION-1
DRAFT 1/5/18
NOT ISSUED FOR CONSTRUCTION



REVISIONS			
NO	BY	DATE	DESCRIPTION

