

UTILITY TEST PIT DATA							
GAS (EVERSOURCE)							
TEST PIT #	BASELINE		NORTHING	EASTING	GROUND ELEVATION (FT)	TOP OF PIPE / UTILITY ELEVATION (FT)	UTILITY DESCRIPTION
	STATION	OFFSET					
TP-12	STA 41+14.28	13.75 RT	692609.45	1172022.96	± 159.70	± 158.45	± 8" MAIN FOUND - PLASTIC

THIS UTILITY INFORMATION IS BASED ON LIMITED FIELD INVESTIGATIONS AND IS PRESENTED FOR INFORMATION PURPOSES ONLY. IN SOME CASES THE FACILITY WAS NOT COMPLETELY EXPOSED TO POSITIVELY VERIFY ITS SIZE OF MATERIAL TYPE. THE CONTRACTOR IS STILL REQUIRED TO COORDINATE ITS CONSTRUCTION ACTIVITIES SO THAT THE UTILITIES ARE PROTECTED AT ALL TIMES.

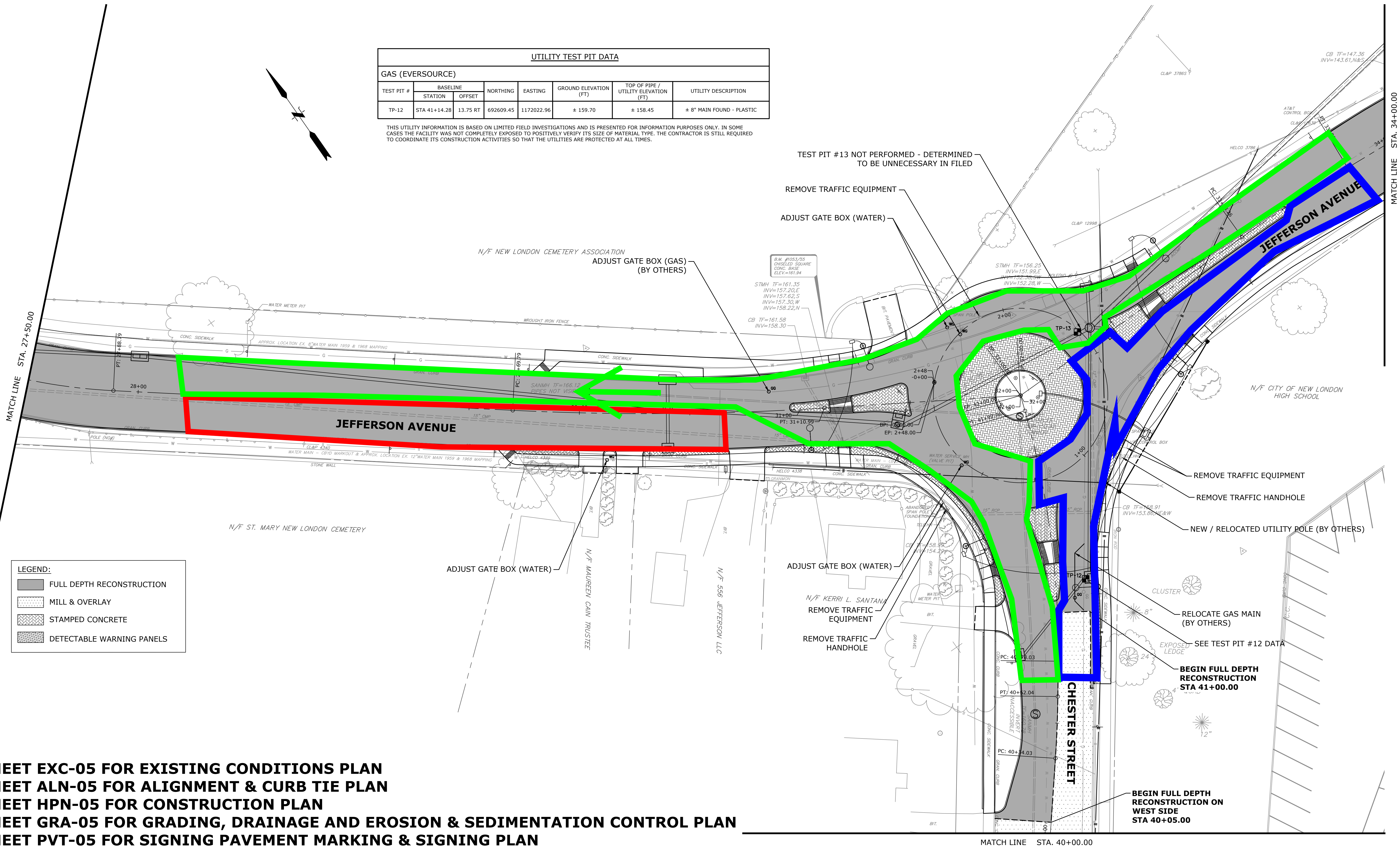

**SEE SHEET EXC-05 FOR EXISTING CONDITIONS PLAN**  
**SEE SHEET ALN-05 FOR ALIGNMENT & CURB TIE PLAN**  
**SEE SHEET HPN-05 FOR CONSTRUCTION PLAN**  
**SEE SHEET GRA-05 FOR GRADING, DRAINAGE AND EROSION & SEDIMENTATION CONTROL PLAN**  
**SEE SHEET PVT-05 FOR SIGNING PAVEMENT MARKING & SIGNING PLAN**

File Path: J:\DWG\2017\05353A20\Civil\Plan\201705353A20\_UTL01.dwg Layout: UTL-05 User: stanski  
 Plotted: Tue, January 25, 2022 - 3:54 PM  
 Plotter: AUTOCAD PDF (GENERAL DOCUMENTATION) PC3 CTB File: FO.STB  
 LAYER STATE:

No.	DATE	DESCRIPTION	DESIGNER	REVIEWER
1.			xx/xx	xx

SEAL

SEAL

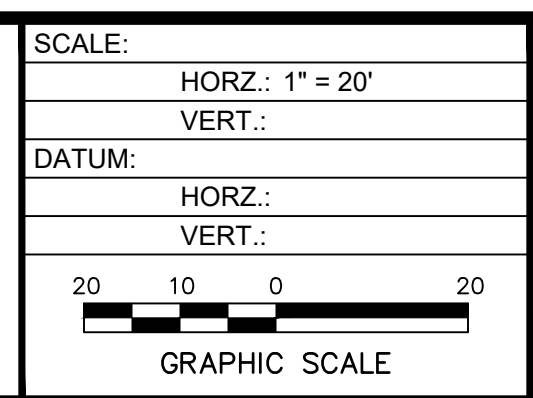

**FUSS & O'NEILL**

146 HARTFORD ROAD  
 MANCHESTER, CONNECTICUT 06040  
 860.646.2469  
 www.fando.com

CITY OF NEW LONDON

UTILITY PLAN

JEFFERSON AVE. AT CHESTER STREET ROUNDABOUT & ROADWAY IMPROVEMENTS

NEW LONDON CONNECTICUT

PROJ. No.: 20170353 A20  
 DATE: FEBRUARY 2022

**UTL-05**